



## Milwards, Harlow, CM19 4SG

Offering flexible family accommodation a four bedroom terraced home offered with no onward chain. The property inside does require some improvement work. It has a large lounge, kitchen/diner, downstairs WC and separate shower.

Milwards is placed on the southern side of town primary and secondary schools nearby. the local shopping centre of Staple Tye is just up the road with super market, post office, fast food restaurants, Bakers and coffee shop.

Price Guide £285,000

# Milwards, Harlow, CM19 4SG



- Four Bedroom House.
- Downstairs WC
- Living Room
- Primary and Secondary Schooling Close By
- Offered with No Onward Chain
- Downstairs Shower Room
- Family Bathroom
- In Need of Work
- Kitchen Diner
- Close To Staple Tye

## Living Room

16'9" x 11'11" (5.11m x 3.63m)

## Kitchen

11'1" x 14'7" (3.38m x 4.45m)

## Down Stairs WC

## Shower Room

## Bedroom

11'x9'6" (3.35mx2.90m)

## Bedroom

10'11x9'7" (3.33mx2.92m)

## Bedroom

8'x8'4" (2.44mx2.54m)

## Bedroom

8'3" x 7'11" (2.51m x 2.41m)

## Family Bathroom



## Directions



# Floor Plan

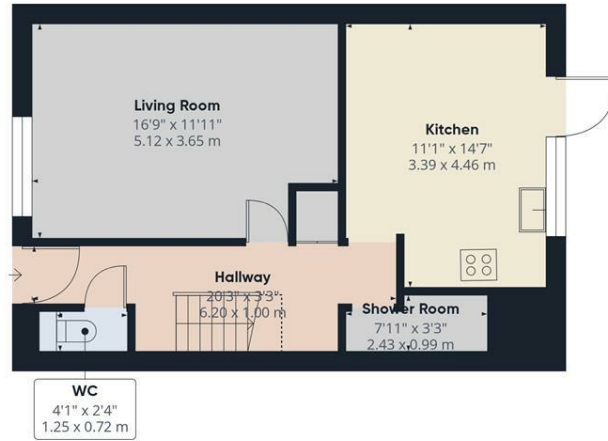

Floor 0

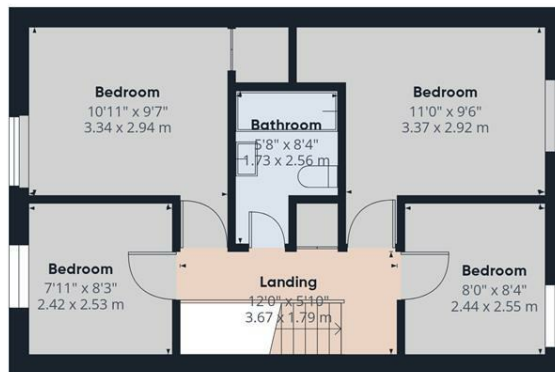

Floor 1



**Approximate total area<sup>(1)</sup>**  
 965 ft<sup>2</sup>  
 89.5 m<sup>2</sup>

**Reduced headroom**  
 16 ft<sup>2</sup>  
 1.5 m<sup>2</sup>

(1) Excluding balconies and terraces

Reduced headroom  
 Below 5 ft/1.5 m

Calculations reference the RICS IPMS 3C standard. Measurements are approximate and not to scale. This floor plan is intended for illustration only.

GIRAFFE360

## Council Tax Details

Band C

These particulars, whilst believed to be accurate are set out as a general outline only for guidance and do not constitute any part of an offer or contract. Intending purchasers should not rely on them as statements of representation of fact, but must satisfy themselves by inspection or otherwise as to their accuracy. No person in this firm's employment has the authority to make or give any representation or warranty in respect of the property.

